





RECOMMENDED FLOW RATES FOR TUBING, UV/Vis FLOW CELLS, AND MIXER BARRELS ON NGC™ CHROMATOGRAPHY SYSTEMS

Tubing

Tubing	Flow Rate, ml/min	Complete System	
		Post Column (low-pressure columns)	Post BioFrac™ Diverter Valve
Orange PEEK 	0–40		
Green PEEK 	20–200		
Clear 0.062" PTFE 	80–200		40–200

PTFE, polytetrafluoroethylene.

UV/Vis Flow Cells

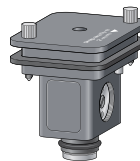

Flow Path Length, mm	Flow Rate, ml/min
10	0.001–20
5	0.001–200*
2	1–200

* 60 psi backpressure at 200 ml/min.

Mixer Barrels

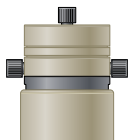

Mixer Barrel Size	F10 Pump		F100 Pump	
	Flow Rate, ml/min		Flow Rate, ml/min	
	Without Buffer Blending Valve (gradient)		Without Buffer Blending Valve (gradient)	
263 µl (base)	0.01–1.00		750 µl (base)	1.00–4.99
750 µl	1.00–9.99		2 ml	5.00–14.99
2 ml	10.00–20.00		5 ml	15.00–39.99
5 ml	N/A		12 ml	40.00–100.00

Visit bio-rad.com/web/ChromComponents for more information about components and accessories for NGC Chromatography Systems.

BIO-RAD



LABORATORY SCALE PROTEIN PURIFICATION COLUMNS AND CARTRIDGES CROSS-REFERENCE GUIDE

GE Healthcare	Bio-Rad	Column Size, ml	Bio-Rad Catalog Number
Mono Q GL	ENrich™ Q	1 and 8	7800001 and 7800003
Mono S GL	ENrich S	1 and 8	7800021 and 7800023
Superdex 200 GL	ENrich SEC 650	24	7801650
Superdex 75 GL	ENrich SEC 70	24	7801070
HiTrap Protein A HP	Bio-Scale™ Mini UNOsphere SUPra™	1 and 5	7324200 and 7324202
GSTrap HP	Bio-Scale™ Mini Profinity™ GST	1 and 5	Pkg of 5: 7324620 and 7324624
HiTrap Desalting	Bio-Scale™ Mini Bio-Gel® P-6 Desalting	5 10 50	7324502 Pkg of 5: 7325304 7325312
HiTrap Q or SP FF	Bio-Scale™ Mini UNOsphere™ Q or S	1 and 5	Pkg of 5 (Q): 7324100 and 7324104 Pkg of 5 (S): 7324110 and 7324114
HiTrap FF	Bio-Scale™ Mini Nuvia™ IMAC	5	7800811

Visit [bio-rad.com/web/PrepackedColumns](https://www.bio-rad.com/web/PrepackedColumns) for more information.

GSTrap, HiTrap, Mono Q, Mono S, and Superdex are trademarks of GE Healthcare. PEEK is a trademark of Victrex plc.