

Quick Start Guide

Installing your GS-900™ Calibrated Densitometer

1. Unpack the GS-900 Calibrated Densitometer

Unpack the box and verify that the following components are included:

1. GS-900 densitometer
2. USB cable
3. Power cord

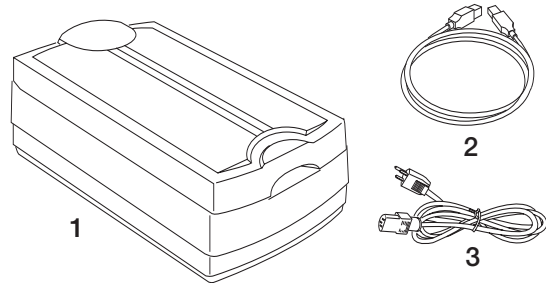

2. Install the Image Lab™ Software

Note: The Image Lab software (Part #170-9690) is delivered in a separate box.

Important: You must install the Image Lab software on your computer before you connect the GS-900 calibrated densitometer to your computer.

1. Before installing the software, close any open programs on your computer and turn off any antivirus utilities.
2. Follow the instructions on the CD sleeve for installing the Image Lab software on your computer.
3. Restart the computer.

Note: Do not start the Image Lab application until you have completed installing the GS-900 densitometer. Turn on any antivirus utilities that you temporarily disabled for the installation.

3. Unlock the GS-900 Base

Before you unlock the GS-900 base, make sure the power is turned off.

1. Remove the yellow sticker with the Unlock label.
2. Locate the locking screw on the bottom, right corner of the densitometer.
3. Use a screwdriver to push in and turn the screw counter-clockwise to the unlocked position.
4. The screw releases and the GS-900 base is now unlocked.

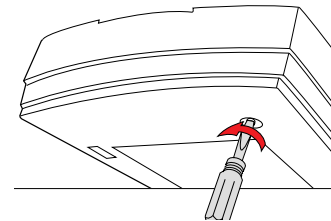

Note: The GS-900 base must be locked before it can be shipped. To lock the densitometer base, push in and turn the screw clockwise to the locked position.

4. Unlock the GS-900 Lid

1. Remove the yellow sticker with the Unlock label.
2. Locate the locking knob under the lid, in the top left corner. Turn the knob counter-clockwise to the unlocked position.

Note: The lid of the GS-900 must be locked before it can be shipped. To lock the lid, turn the locking knob clockwise to the locked position.

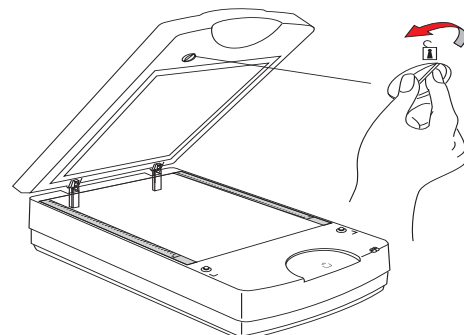

5. Connect the Power Cord

1. Connect the power cord to the back of the GS-900 densitometer.
2. Plug the power cord into a grounded power source.

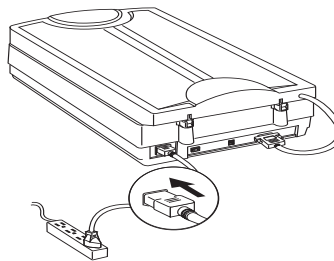

6. Connect the USB Cable

1. Connect one end of the USB cable to the GS-900 densitometer.
2. Connect the other end of the USB cable to your computer.

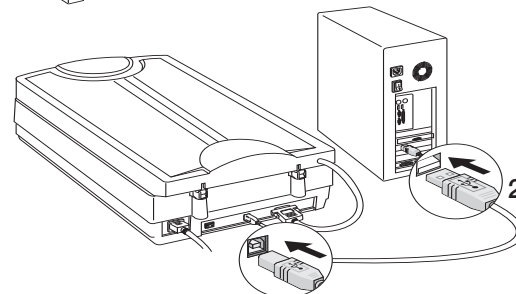

7. Turn the GS-900 Densitometer On

Note: Be sure the lid on the GS-900 densitometer is closed before you turn the power on. If the lid is left open, the calibration will fail.

The first time the GS-900 densitometer is powered up, it goes through a scanner calibration process that takes a few minutes. Once the LED lights on the front panel stop blinking and remain on, the installation is completed and you may start the Image Lab application on your computer.

Microsoft Windows then automatically starts the process to install the drivers for the GS-900 densitometer on the computer. Follow the prompts to install the drivers. For more information, refer to the GS-900 System with Image Lab Software User Guide.

LED Lights

- The amber Power light indicates whether the densitometer is turned on or off
- The green Ready light indicates the current status of the GS-900 densitometer. A steady green light indicates the densitometer is ready to scan. A blinking green light means the densitometer is in use

Problems with Your Installation?

If you encounter any difficulties with the installation of the GS-900 calibrated densitometer or the Image Lab software, contact Bio-Rad Technical Support for assistance.

Bio-Rad Technical Support Department

The Bio-Rad Technical Support department in the U.S. is open Monday through Friday, 5:00 AM to 5:00 PM, Pacific Time. Worldwide technical support is available on the Web at www.consult.bio-rad.com.

Phone: 1-800-424-6723, option 2

Fax: 1-510-741-5802

Email: LSG.TechServ.US@Bio-Rad.com (U.S.)
LSG.TechServ.Intl@Bio-Rad.com (International)

Web: www.consult.bio-rad.com

Address: 2000 Alfred Noble Drive
Hercules, CA 94547
USA

Windows and Microsoft are trademarks of Microsoft Corporation.



Bio-Rad
Laboratories, Inc.

Life Science
Group

Web site www.bio-rad.com USA 800 424 6723 Australia 61 2 9914 2800 Austria 01 877 89 01 Belgium 09 385 55 11 Brazil 55 11 5044 5699
Canada 905 364 3435 China 86 21 6169 8500 Czech Republic 420 241 430 532 Denmark 44 52 10 00 Finland 09 804 22 00
France 01 47 95 69 65 Germany 089 31 884 0 Greece 30 210 9532 220 Hong Kong 852 2789 3300 Hungary 36 1 459 6100 India 91 124 4029300
Israel 03 963 6050 Italy 39 02 216091 Japan 03 6361 7000 Korea 82 2 3473 4460 Mexico 52 555 488 7670 The Netherlands 0318 540666
New Zealand 64 9 415 2280 Norway 23 38 41 30 Poland 48 22 331 99 99 Portugal 351 21 472 7700 Russia 7 495 721 14 04
Singapore 65 6415 3188 South Africa 27 861 246 723 Spain 34 91 590 5200 Sweden 08 555 12700 Switzerland 026 674 55 05
Taiwan 886 2 2578 7189 Thailand 800 88 22 88 United Kingdom 020 8328 2000