



# in2it™

Quick Reference Guide

**BIO-RAD**

# in2it™ A1C Test Procedure

## Getting Started

- Test cartridges must be warmed to room temperature for two hours
- Consult the user manual for instructions on collecting control or venous samples

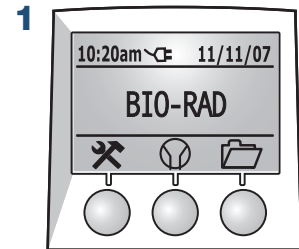

When the in2it™ is ready to run a test, the cartridge symbol will flash. Press the middle button (under the cartridge symbol), to start a test.

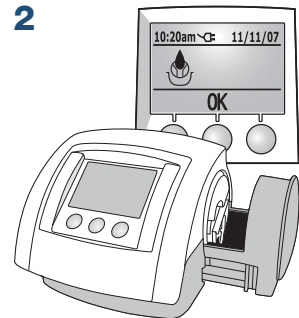

The in2it™ door will open. It is ready to accept a cartridge.



Place a cartridge in the cartridge workstand with the blue blood port facing up.

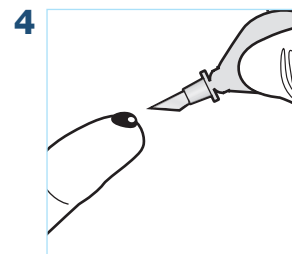

With a sterile lancet, prick the patient's finger and gently squeeze to obtain a generous drop of blood.

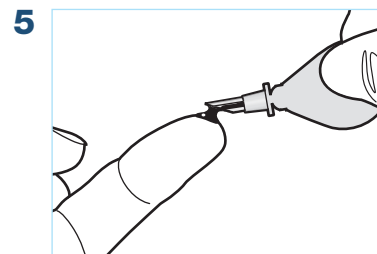

Holding the blood key by the round handle, touch the flat end to the blood drop. Blood will automatically flow into the key. Take care not to get blood on the outside of the blood key. (See Figure A)

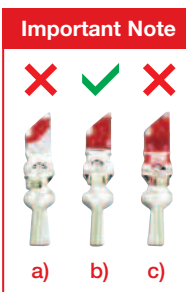

**Figure A:**  
The illustration shows:  
a) an under filled  
b) correctly filled  
c) over filled blood key

Continues inside fold on opposite page >

## 6. Introducing Sample into the Test Cartridge

Proper insertion of blood key into the test cartridge is essential. Please read the following detailed instructions carefully.

Be sure to introduce the sample **within 10 seconds**, following the steps below:

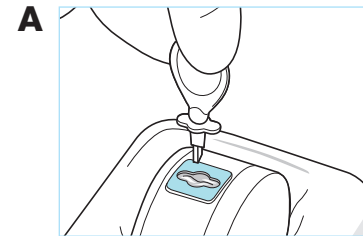

### Align

Properly align the blood key prior to pressing the key through the blue blood port. The winged flanges on the blood key must face the same direction as the notch in the blood port.

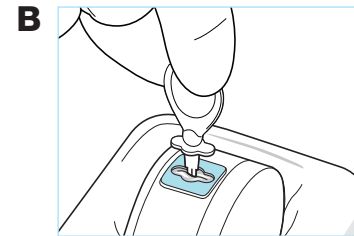

### Pierce

Pierce the film covering the blue blood port. The blood key will drop slightly into the port.

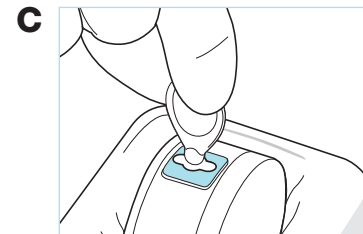

### Push

Press **FIRMLY** down on the blood key until it locks in position. **You may feel two separate and distinct clicks.**

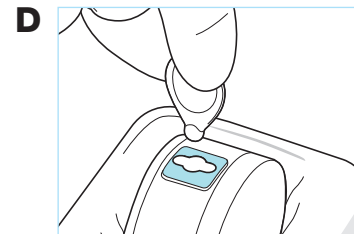

### Twist

Twist the handle of the blood key until it snaps off.

### Important Note

Ensure the blood key is smooth with the surface of the test cartridge. **This may require EXTRA pressure.**

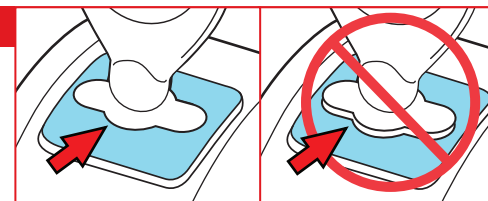

Correct

Incorrect

< Continued from bottom of left page

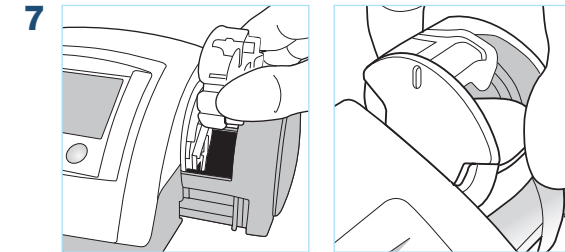

**Immediately** (within 10 seconds), place the cartridge in the door with the white plate facing inward and the blue blood port facing up.

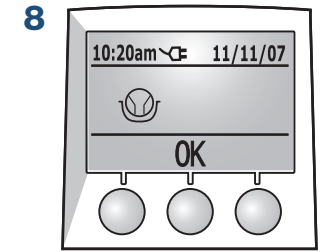

**Immediately** (within 10 seconds), press the OK button to close the door. Testing will start automatically.

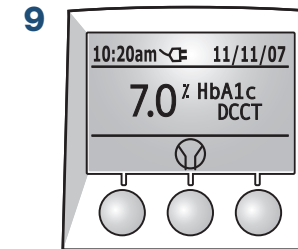

When the test is completed, the result will be displayed. Record the result.



Press the cartridge symbol button to open the door and remove the cartridge. **After removing the cartridge, press the OK button to close the door.**

### Important Note

The in2it™ door must be closed before another test can be performed. **DO NOT INSERT NEW TEST CARTRIDGE BEFORE CLOSING DOOR.**

### Important Note



If a new test cartridge is inserted before closing the door, the test will be rejected and this symbol will appear.

# in2it™ System Check Cartridge Procedure

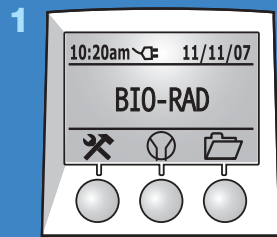

When the in2it™ is ready to run a test, the cartridge symbol will flash. Press the middle button under the cartridge symbol to start a test.

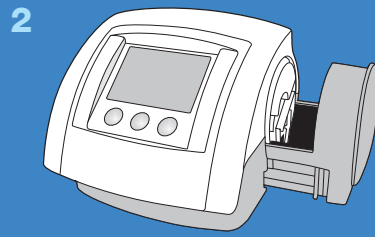

The in2it™ door will open. It is ready to accept the System Check Cartridge.

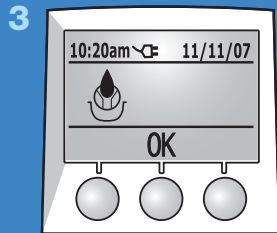

The display screen will show a blood drop entering a cartridge.

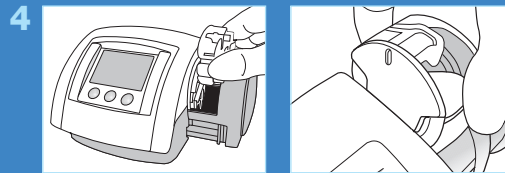

Remove the System Check Cartridge from its protective case. Place the System Check Cartridge in the door with the red plate facing inward and the long end pointing downward.

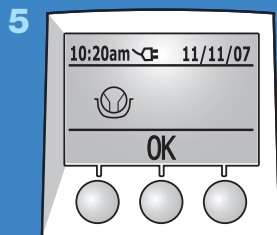

Press the OK button to close the door and run the System Check Cartridge.

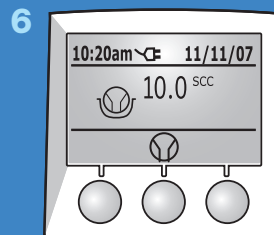

When the System Check Cartridge run is finished, the result will be displayed. Record the result.

7 Press the cartridge symbol button to open the door and remove the System Check Cartridge. Replace the System Check Cartridge in its protective case. Press the OK button to close the door.

## in2it™ Display Symbols

### Assay Procedure

- Wait for this symbol to disappear before starting a test.
- Press the button under this symbol to run a test.
- This symbol appears at the start of a test. Take a blood sample and add it to the test cartridge.
- These symbols appear as a moving sequence. Place the cartridge in the door and start the test.
- When the test is completed, this symbol prompts the operator to dispose of the test cartridge. A beep will warn the operator that the door is opening. Remove cartridge and press OK. **Do not insert new test cartridge before closing the door.**

### Data Management

- Press the button under this symbol to access test results stored in memory.
- Select this option to print a single result or all results from a specified day.

### in2it™ Setup

- Prints all results from a specified day.
- Pressing the button under this symbol leads to the menu to set the user language, date, time and the option to collect patient and operator identification information.
- Press the button under this symbol to select the user language.
- Press the button under this symbol to set the time and date.
- Press the button under this symbol to configure the in2it™ to capture patient and/or operator identification information.

- Appears when the in2it™ is connected to an electrical power supply.
- Appears when batteries are inserted. The dark battery shows sufficient power to run a test. The clear battery shows insufficient power to run a test.

**Note:** The in2it™ door must be closed before another test can be performed.



Bio-Rad  
Laboratories

For further information, please contact the Bio-Rad office nearest you or visit our website at [www.bio-rad.com/diagnostics](http://www.bio-rad.com/diagnostics).